

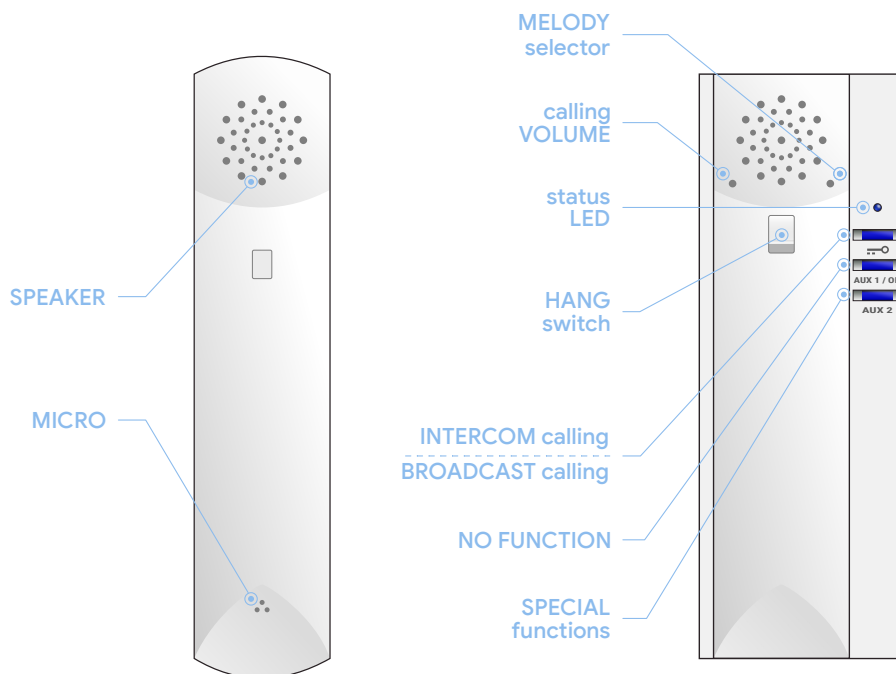

# COMPACT INTERCOM INTERNAL handset



- dimensions 79 (wi) x 217 (hi) x 50 (de) mm
- surface mounting
- call volume selection
- melody selection
- No. of tones selection
- DING DONG function (flat bell)
- external functions (lights, garage, etc...)
- BROADCAST CALLING function
- self-starting function
- INTERCOM up to 6 points

## calling and conversation

When a call is received from another terminal, the phone starts ringing for a maximum of 30 seconds. As standard, it performs 4 rings with intervals of 4 seconds between each of them.

During the call period, the user can pick up the handset to establish a conversation. The conversation has a maximum of 90 seconds. If you want to continue with the conversation make a new intercom calling to the same device.

## INTERCOM calling

When the phone is on standby, press the button  as many times as the internal device number you wish to call. The phone makes a confirmation tone with each press and the status LED flashes as many times as the device number to which the call will be made. After the handset is picked up, the system will activate automatic communication with the selected phone.

## broadcast calling function

With the phone in standby press the button  during 3 seconds, the LED starts blinking fast. When you pick up the handset it will make a calling to all devices installed at system.

## adjust of the calling volume

To adjust the volume of the call, insert a clip or similar through the indicated hole and press with it lightly.

The phone has two volume levels (MEDIUM and HIGH)

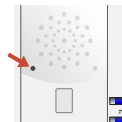

## melody selection

To select a ring tone, you have to pick up the handset and press the hang switch with your finger. With it pressed, a clip or similar must be inserted in the indicated hole and press with it lightly.

Each press selects a different melody from 8 ones available.

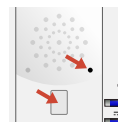

## ding dong function

The phone allows to replace the interior bell of the house, this integrates the two calls (outside panel and house bell) in a single device. These calls will be differentiated with different melodies and flashes automatically. In order to have this function, you only have to connect the button of the house bell to the phone.

## external functions

The monitor has 1 independent push-button that allow auxiliary functions, such as garage doors, lights, irrigation, etc ...

To do this, an Auta auxiliary relay must be connected to the control circuit we want to control.