

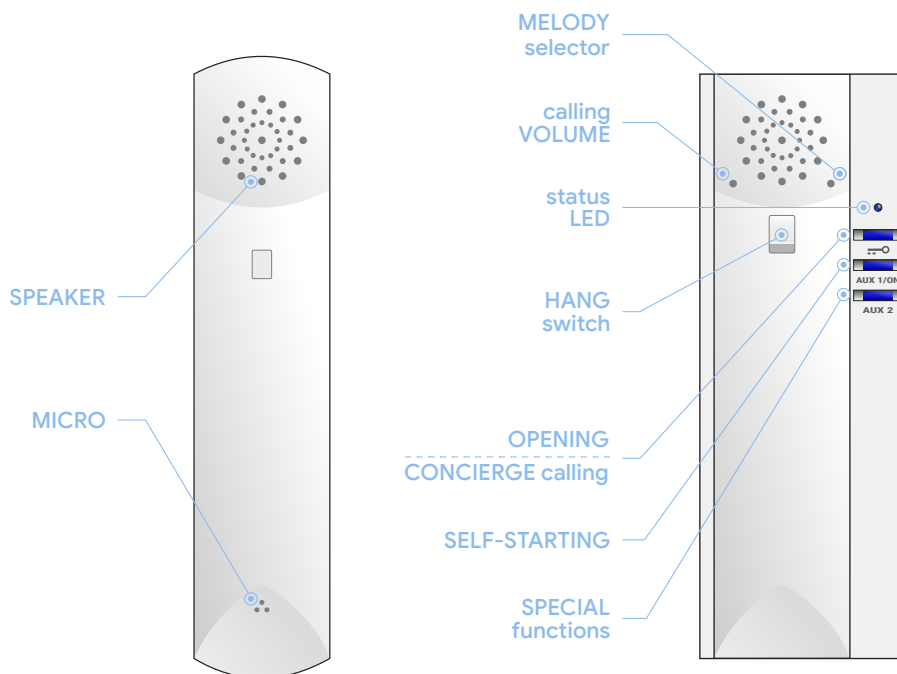



COMPACT DIGITAL 2W handset



- dimensions 79 (wi) x 217 (hi) x 50 (de) mm
- surface mounting
- call volume selection
- melody selection
- No. of tones selection
- DING DONG function (flat bell)
- external functions (lights, garage, etc...)
- AUDIO HD system
- self-starting function
- door sensor function

calling and conversation

When a call is received from the entrance panel, the monitor starts ringing for a maximum of 30 seconds. As standard, it performs 4 rings with intervals of 4 seconds between each of them.

During the call period the image appears on the screen, the user can open directly, pressing the button , or pick up the handset to establish conversation. The conversation has a maximum of 90 seconds. If you want to continue with the conversation, press the button 

self-starting

By pressing the button  the user can establish communication with the PANEL / CCTV CAMERA that he wishes in the case of more than one is present in the installation.

With each press the system will automatically switch to the next device, showing the image and allowing the opening of it by pressing the button 

adjust of the calling volume

To adjust the volume of the call, insert a clip or similar through the indicated hole and press with it lightly.

The monitor has two volume levels (MEDIUM and HIGH)

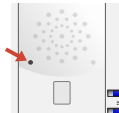

melody selection

To select a ring tone, you have to pick up the handset and press the hang switch with your finger. With it pressed, a clip or similar must be inserted in the indicated hole and press with it lightly.

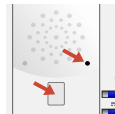

Each press selects a different melody from 8 ones available.



ding dong function

The monitor allows to replace the interior bell of the house, this integrates the two calls (outside panel and house bell) in a single device. These calls will be differentiated with different melodies and flashes automatically. In order to have this function, you only have to connect the button of the house bell to the monitor.

privacy function

The monitor incorporates a privacy mode in which the ringing tones are muted for a selected time. If the privacy mode is active, the monitor shows by flashes the selected period of time (1 flash - **2 hours**, 2 flashes - **4 hours**, 3 flashes - **8 hours**). After the selected period of time finished, the monitor automatically returns to standard mode. To activate the privacy mode press the button  for 4 seconds (LED will start to blink), select the desired period of time by pressing the button . Each press will activate a different period of time between the 3 available ones.

function door sensor

If a door contact is installed, the monitor allows monitoring, in real time, the entrance to the building. If the door remains open for a longer period of time than stipulated in the settings, the system sends a visual alarm to all the monitors of the installation that remains active until the door is closed correctly.