

auta



REF: 721187

ES LECTOR PROXIMIDAD 4K PRO

EN 4K PRO PROXIMITY READER

auta

Bringing people together

Especificaciones

Tecnología	Lector proximidad (125 KHz, HID o EM)
Gestión	mediante mando a distancia incluido o tarjetas de sistema
Tipo de lectura de proximidad	EM 4002_4100 y HID (125kHz)
Distancia de lectura	de 2 a 5 cm
Interfaz	Wiegand 26, 34
Capacidad	10000 usuarios
Zumbador	Sí
Consumo	Max. 35 mA
Clasificación IP	65
Alimentación	12-24 CC/CA
Temperatura de funcionamiento	de -20°C a +60°C
Humedad de funcionamiento	de 0% a 95%
Relé	contacto libre NA - COM - NC, máximo 2A
Dimensiones (mm)	45 (an) x 103 (al) x 20 (pr) mm
Carcasa	Plástico de alto impacto moldeado



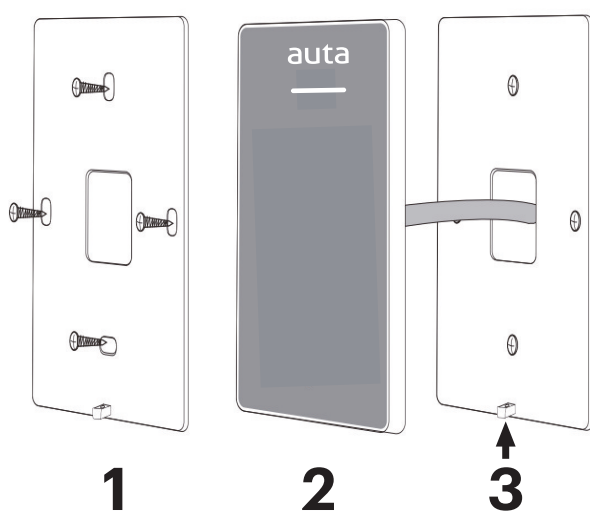

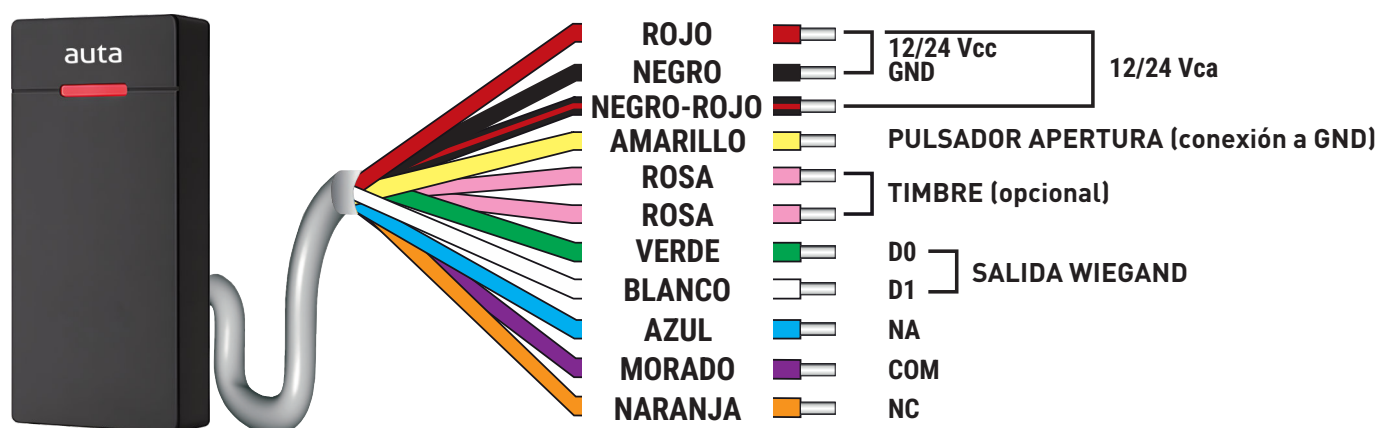

Montaje



Cableado



Indicaciones del LED de estado

	Reposo	Fijo
	Operación OK / Puerta abierta	Fijo
	Error	
	Modo programación tarjeta ADMIN	
	Salir modo programación tarjeta ADMIN	
	Modo programación al pulsar * en mando	
	Modo programación	Parpadeo lento

Programación mediante MANDO A DISTANCIA

Cambio código MASTER

* MASTER # 0 NUEVO MASTER # NUEVO MASTER # Fábrica 999999
6 DÍGITOS

Añadir usuarios

AÑADIR TARJETA * MASTER # 1 LEER TARJETA # ... # Se pueden añadir tarjetas de forma consecutiva

AÑADIR Nº TARJETA * MASTER # 1 MARCAR Nº TARJETA #
8 o 10 DÍGITOS

Borrar usuarios

BORRAR TARJETA * MASTER # 2 LEER TARJETA # ... # Se pueden añadir tarjetas de forma consecutiva

BORRAR Nº TARJETA * MASTER # 2 MARCAR Nº TARJETA #
8 o 10 DÍGITOS

Borrar TODOS

BORRAR TODOS * MASTER # 2 0000 #

Tiempo de conmutación de relé

* MASTER # 4 NUEVO TIEMPO #
0 a 99

Tiempo que permanecerá el relé activo en segundos. Por defecto 5 segundos.

Modos de funcionamiento

* MASTER # 5 0 #

Modo pulso. El relé se activa y desactiva al pasar el tiempo definido (5s por defecto)

* MASTER # 5 1 #

Modo interruptor. El relé se activa al pasar la tarjeta y se desactiva al volverla a pasar.

* MASTER # 5 2 #

Modo lector. La salida Wiegand D0 y D1 queda activa. Enviando los datos a controladoras.

Programación mediante TARJETAS DE SISTEMA

Añadir usuarios

AÑADIR TARJETA LEER TARJETA ADD LEER TARJETA USER ... LEER TARJETA ADD

Se pueden añadir tarjetas de forma consecutiva

Borrar usuarios

BORRAR TARJETA LEER TARJETA DELETE LEER TARJETA USER ... LEER TARJETA DELETE

Se pueden borrar tarjetas de forma consecutiva

Borrar TODOS

BORRAR TODOS LEER TARJETA DELETE LEER TARJETA ADD LEER TARJETA DELETE

Ajuste tiempo de desbloqueo de relé

1 SEGUNDO LEER TARJETA ADD LEER TARJETA SETTING LEER TARJETA DELETE

5 SEGUNDOS LEER TARJETA ADD LEER TARJETA SETTING x 2 LEER TARJETA DELETE

10 SEGUNDOS LEER TARJETA ADD LEER TARJETA SETTING x 3 LEER TARJETA DELETE

Fábrica

Valores de fábrica



1º Apagar lector

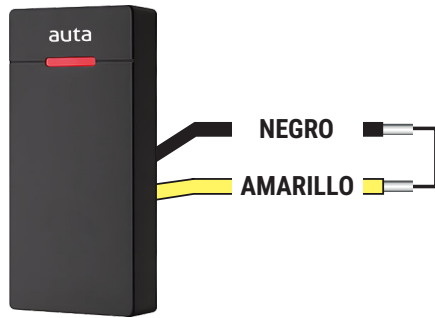

2º Hacer puente

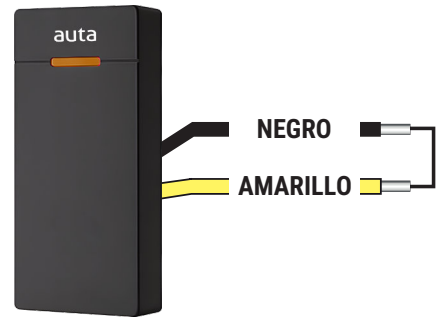

3º Encender lector

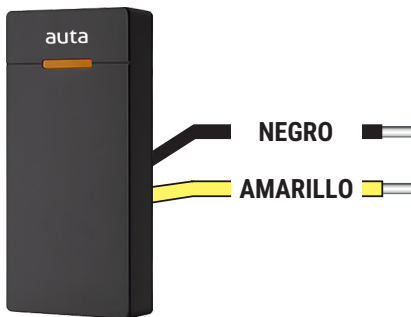

4º Al escuchar Tik-Tik quitar el puente



5º Esperar 10 segundos hasta oír Tik

El código maestro pasará a ser 9 9 9 9 9, los datos de usuarios NO se eliminarán al realizar este proceso.

Dar de alta nuevas tarjetas ADD, DELETE, SYSTEM



1º Apagar lector

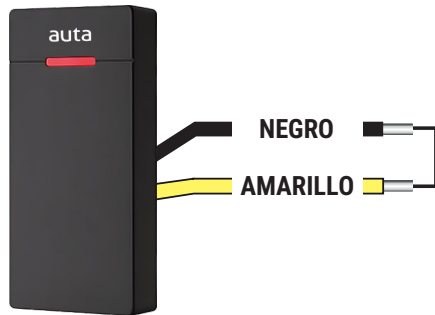

2º Hacer puente

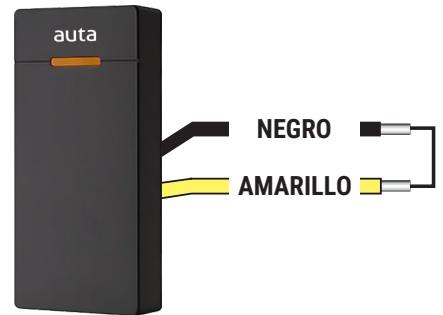

3º Encender lector

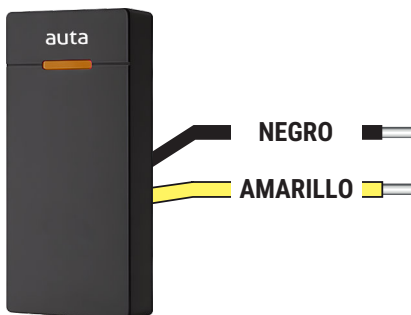

4º Al escuchar Tik-Tik quitar el puente

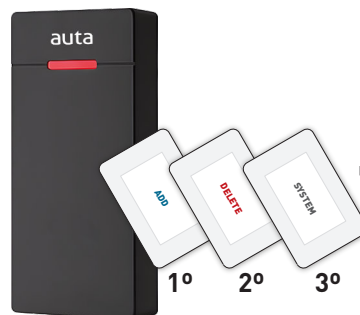

5º Pasar tarjetas ADD, DELETE, SYSTEM

Los datos de usuarios NO se eliminarán al realizar este proceso.

Specifications

Technology	Proximity reader (125 KHz, HID o EM)
Management	via remote control included or system cards
Type of proximity read	EM 4002_4100 y HID (125kHz)
Read distance	from 2 to 5 cm
Interface	Wiegand 26, 34
Capacity	10000 users
Buzzer	Yes
Consume	Max. 35 mA
IP classification	65
Supply	12-24 AC/DC
Working temperature	from -20°C to +60°C
Working humidity	from 0% to 95%
Relay	NO - COM - NC free contact, max 2A
Dimensions (mm)	45 (w) x 103 (h) x 20 (d) mm
Case	High-impact molded plastic

Montaje

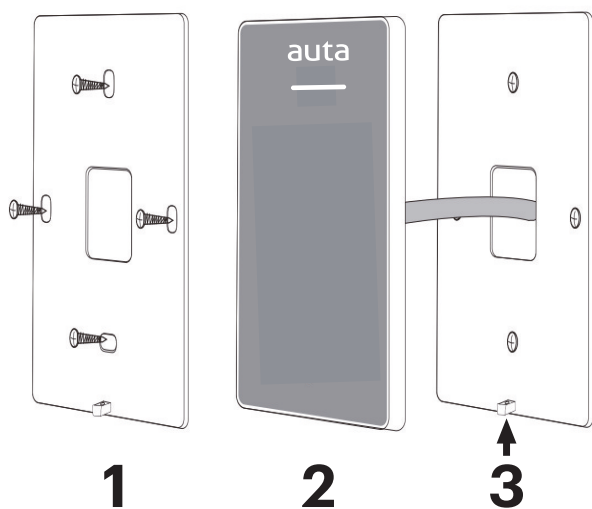

Wiring

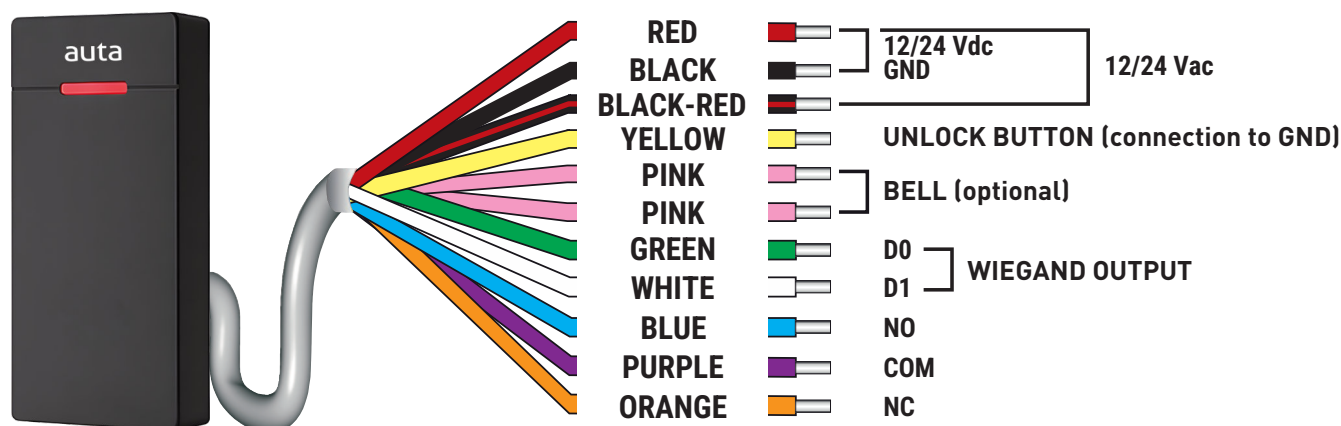

Status LED indications

	Standby	Fix
	Operation OK / Door unlocked	Fix
	Error	
	Programming mode, ADMIN card	
	Exit programming mode, ADMIN card	
	Programming mode if press * at remote	
	Programming mode	Slow blink

Programming via REMOTE CONTROLLER

Change MASTER code

* MASTER # 0 NEW MASTER # NEW MASTER # Factory 999999
6 DIGITS

Add users

ADD CARD * MASTER # 1 READ CARD # ... # Cards can be added consecutively

ADD CARD N° * MASTER # 1 INTRODUCE CARD N° #
8 or 10 DIGITS

Delete users

DELETE CARD * MASTER # 2 READ CARD # ... # Cards can be added consecutively

DELETE CARD N° * MASTER # 2 INTRODUCE CARD N° #
8 or 10 DIGITS

Delete ALL

DELETE ALL * MASTER # 2 0000 #

Relay switching time

* MASTER # 4 NEW TIME #
0 to 99

Time the relay will remain active in seconds. Default: 5 seconds.

Functioning modes

* MASTER # 50 #

Pulse mode. The relay activates and deactivates after a defined time (5s by default).

* MASTER # 51 #

Switch mode. The relay is activated when the card is swiped and deactivated when it is swiped again.

* MASTER # 52 #

Reader mode. Wiegand outputs D0 and D1 are active, sending data to controllers.

Programming using SYSTEM CARDS

Add users

ADD CARD READ ADD CARD READ USER CARD ... READ USER CARD

Cards can be added consecutively

Delete users

DELETE CARD READ DELETE CARD READ USER CARD ... READ USER CARD

Cards can be added consecutively

Delete ALL

DELETE ALL READ DELETE CARD READ ADD CARD READ DELETE CARD

Relay unlock time adjustment

1 SECOND READ ADD CARD READ SETTING CARD READ ADD CARD

5 SECONDS READ ADD CARD READ SETTING CARD x 2 READ ADD CARD

10 SECONDS READ ADD CARD READ SETTING CARD x 3 READ ADD CARD

Factory

Factory settings



1° Power off

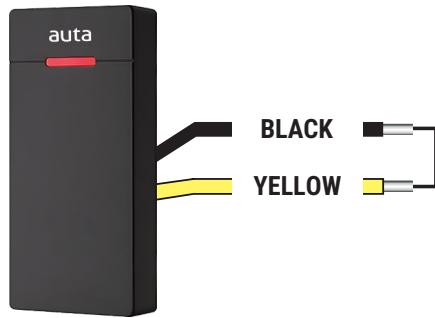

2° Make a bridge

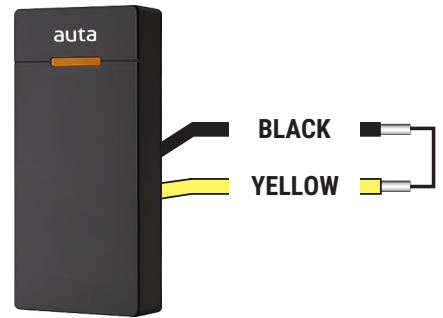

3° Power on

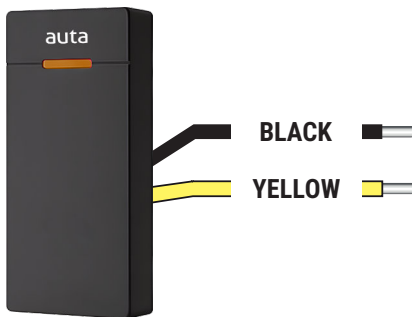

4° When listen Tik-Tik remove bridge



5° Wait 10 seconds until listen Tik

The master code will become 9 9 9 9 9, user data will NOT be deleted when performing this process.

Register new cards ADD, DELETE, SYSTEM



1° Power off

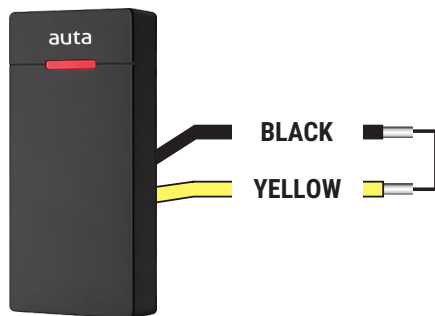

2° Make a bridge

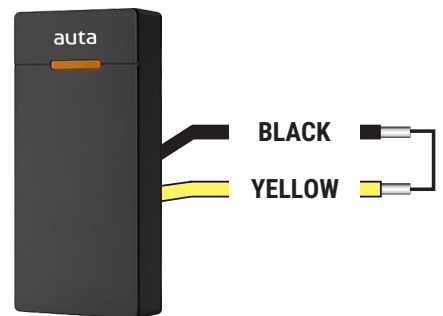

3° Power on

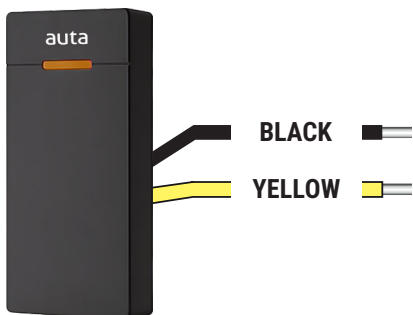

4° When listen Tik-Tik remove bridge

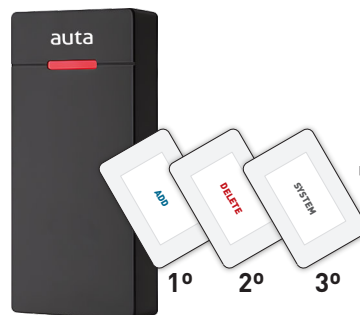

5° Swipe cards ADD, DELETE, SYSTEM

User data will NOT be deleted when performing this process.

